



**BC SPORTS
HALL OF FAME**
AND MUSEUM



BC Sports Hall of Fame

Special Events

2009 / 2010



BC SPORTS
HALL OF FAME
AND MUSEUM

Table of Contents

INTRODUCTION	3
LOCATION	4
FACILITY DESCRIPTION	4
VENUE RENTAL	7
CATERING AND RENTALS	10
RENTAL FEES	11
BOOKING	13
FREQUENTLY ASKED QUESTIONS	14

INTRODUCTION

Immerse yourself in over 100 years of the rich sport heritage of British Columbia. 310 individuals and 54 teams have been inducted into the BC Sports Hall of Fame and Museum since 1966. Using the stories of our athletes and our expansive collection of over 25,000 sports artifacts and 20,000+ images, the BC Sports Hall of Fame inspires, motivates and educates individuals to pursue their dreams and to find the hero within.

Sport has enormous potential to define how we live and learn, to shape and define who we are. Your experience here at the BC Sports Hall of Fame and Museum begins with the stories of our athletes who have accomplished greatness and brought pride to British Columbia and to Canada.

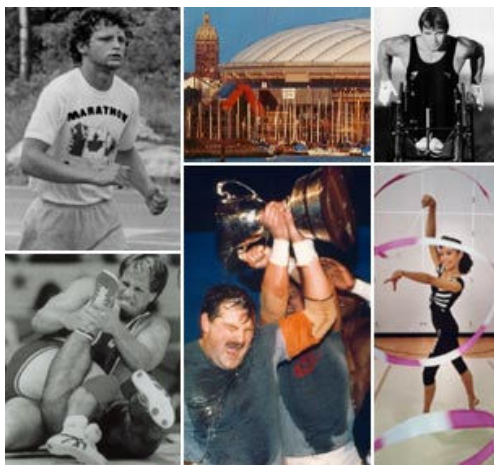

LOCATION

The BC Sports Hall of Fame and Museum (BCSHFM) is strategically located in downtown Vancouver, British Columbia, physically located within BC Place, home to the Opening and Closing Ceremonies of the 2010 Olympic and Paralympic Winter Games.

While at the BC Sports Hall of Fame, guests are enthralled, entertained and educated through interactive exhibits, videos and displays – and always inspired.



FACILITY DESCRIPTION

Within 20,000 square feet of exhibit space, our visitors are engaged and amazed at the stories of the most extraordinary accomplishments in sport in British Columbia. BC Sports Hall of Fame celebrates truly unique Olympic and Paralympic stories, including:

- a. 24 inductees who have won Olympic gold medals
- b. 27 inductees who have won Olympic silver medals
- c. 25 who have won Olympic bronze medals
- d. 51 inductees who have been involved with the Olympics in a role other than athlete
- e. 1000+ Olympic/Paralympic artifacts representing BC's success in competing on the world stage

MUSEUM GALLERIES – The Sports Hall boasts more than twenty galleries featuring BC sports highlights and stories that include British Columbia’s Olympic and Paralympic accomplishments showcased in the *Olympic Inspirations* Gallery, galleries dedicated to Canada’s greatest heroes, Terry Fox and Rick Hansen and the Aboriginal Sport Gallery, the only one of its kind in North America.



PARTICIPATION GALLERY – Connect with your sport heroes through interactive games, including a rotating climbing wall, multi-sport simulator, racecar simulator and 14 meter timed running track.



VIEWING WINDOW LOOKING INTO BC PLACE – This one of a kind feature enhances the guest experience with a view inside 60,000 seats in the air-supported dome, home to the Opening, Closing Ceremonies, and evening medal ceremonies for the 2010 Winter Games.



VENUE RENTAL

The BC Sports Hall of Fame and Museum's unique design and ideal downtown location makes the facility ideal leading up to and during the 2010 Winter Games. The colourful and vibrant galleries provide a dynamic background for a variety of functions such as press conferences, receptions, product launches, board meetings, seminars, team building meetings and special themed events.

- **OLYMPIC INSPIRATIONS GALLERY** - 1,500 square feet – an ideal and extremely unique location for hosting clients and engaging employees leading up to and including the Olympic and Paralympic Games. Complete with performance stage, audiovisual equipment and a backdrop of Olympic and Paralympic images and artifacts, this is an ideal venue for sit down dining and larger receptions. Capacities include:
 - Stand Up Reception: 250 people
 - Sit down Dinner: 100 people
 - Media Conference: 200 people
 - Board Meeting: 35 people

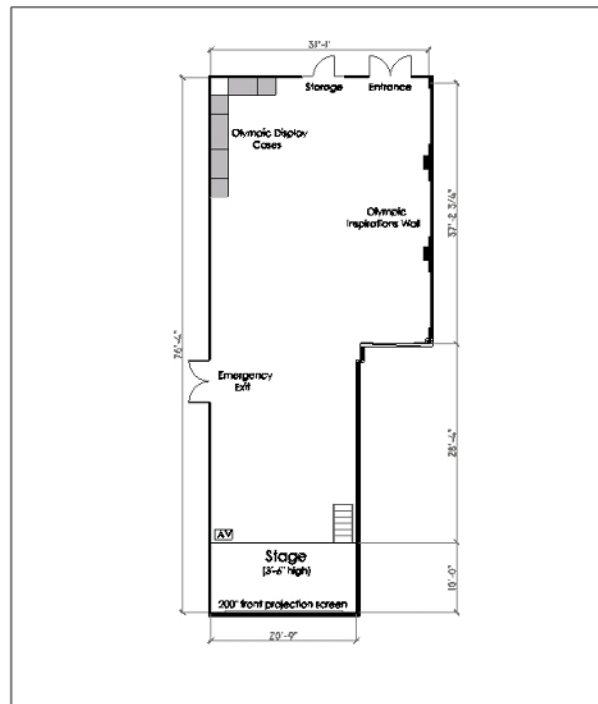



Olympic Inspirations Gallery - Luncheon



Olympic Inspirations Gallery - Presentation

- **2010 EXHIBIT SPACE** – 300 square feet celebrating the values of the Olympic and Paralympic Games available for evening rental. An ideal location for stand up cocktail receptions and intimate press events.

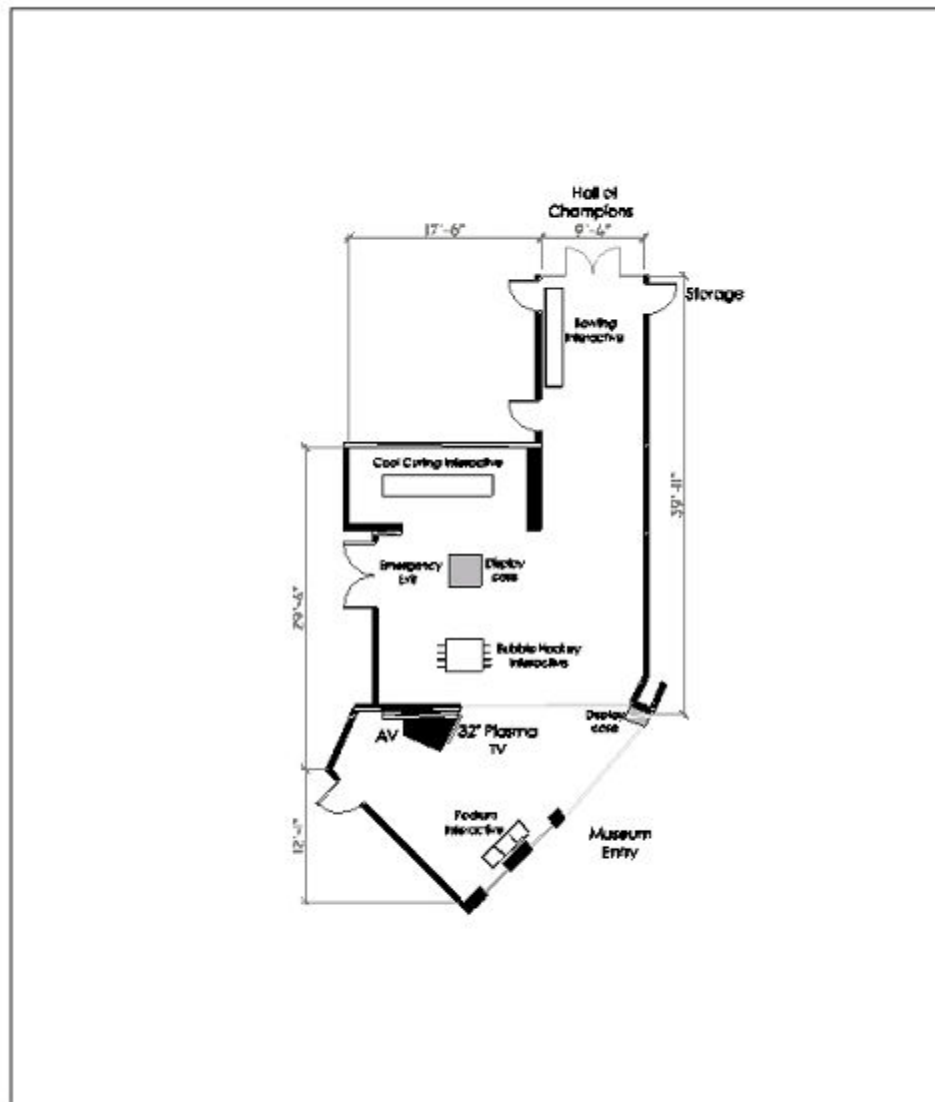



2010 Exhibit Space – Registration/Foyer Area



2010 Exhibit Space – Intimate Presentation

CATERING AND RENTALS

Until December 31, 2009, clients may bring in their own caterer and event rentals on prior approval by the BC Sports Hall of Fame. As of January 1, 2010, catering and rentals will be restricted to the official supplier of BC Place, Centerplate.

RENTAL FEES

SEPTEMBER 15, 2009 – JANUARY 31, 2010

Daytime Rental

- Exclusive use of the *Olympic Inspirations* Gallery, with access to the public museum galleries, including the 2010 Exhibit Space
- 9am-5pm (inclusive of load in/out)
- \$500.00 plus applicable taxes

Media Conference Rental*

- Exclusive use of the *Olympic Inspirations* Gallery, with access to the public museum galleries, including the 2010 Exhibit Space
- 9am-1pm or 1pm-5pm (inclusive of load in/out)
- \$250.00

* rate applies for Media Conference events only

Evening Rental

- Exclusive use of the *Olympic Inspirations* Gallery, 2010 Exhibit Space and museum galleries
- 5pm-midnight (inclusive of load in/out)
- \$1,200.00 plus applicable taxes

Exclusive Rental

- Exclusive use of the *Olympic Inspirations* Gallery, 2010 Exhibit Space and museum galleries
- 9am – midnight (inclusive of load in/out)
- \$8,000.00 plus applicable taxes

RENTAL FEES - FEBRUARY 1, 2010 - MARCH 21, 2010

Please note that rental in the BC Sports Hall of Fame during this period applies to accredited organizations/individuals only.

Evening Rental

- Exclusive use of the *Olympic Inspirations*® Gallery, 2010 Exhibit Space and museum galleries
- 5pm-8pm
- \$1,500.00 plus applicable taxes

Exclusive Rental

- Exclusive use of the *Olympic Inspirations*® Gallery, 2010 Exhibit Space and museum galleries
- 8:30am – midnight (load in/out to take place from midnight to 6am)
- \$12,000.00 plus applicable taxes

INCLUDED IN YOUR VENUE RENTAL

- 100 - Blue chairs
- 6 - 8 foot banquet tables, with linens
- 2 - short pedestal tables, with linens
- 1 - Event host
- AV equipment, including projector and screen, microphone and podium, DVD player, VCR, media board and laptop connection

ADDITIONAL COSTS

- Event staff (as determined by the BC Sports Hall of Fame) - \$25/hr per staff
- Venue access prior to 9am and after midnight -\$100 per hour. As of February 1, 2010, venue access is restricted to midnight to 6am.
- **BE INSPIRED. Ask us about having a BC Sports Hall of Fame Inductee speak at your event!**

BOOKING

For rental of the facility, please contact Sarah Kinsella, Event Manager at **604-687-5520 extension 32** or by email sarah@bcsportshalloffame.com. We are eager to help make your event a memorable and special experience.



BC SPORTS
HALL OF FAME
AND MUSEUM

FREQUENTLY ASKED QUESTIONS

Booking Process

Q. What is the booking process?

A. If you are interested in hosting your next event at the BC Sports Hall of Fame, please call **Sarah Kinsella** at **604.687.5520 extension 32** to discuss your event, date of choice and schedule a site visit. Once the site visit has occurred and the event is confirmed, a rental agreement will be sent to you for signing, a credit card number will be kept in our files and a 25% deposit is due.

Q. When is the deposit and final payments due?

A. A 25% deposit is required for all bookings and due immediately following the signing of the rental agreement. The remaining 75% is due seven (7) days prior to the event.

Q. What is the cancellation policy?

A. If you cancel the event within:

- 30+ days, you will be charged a \$50 administration fee, and the remainder of the deposit will be refunded.
- 15-29days, your credit card on file will be charged 50% of the rental fee.
- 0-14 days, your credit card on file will be charged 100% of the rental fee.

Security

Q. What will access and security be like leading up to and during the 2010 Games?

A. The BC Sports Hall of Fame has an authorized, exclusive access from the Terry Fox Plaza. Guests will be asked to go through a security check, similar to the Airport, prior to accessing the facility.

Q. Can I bring a knapsack with food and drink into the BC Sports Hall of Fame?

A. Due to security requirements, knapsacks will be screened prior to entry and guests will not be allowed to bring food and beverage into the museum.

Access and Parking

Q. Where is the BC Sports Hall of Fame?

A. The BC Sports Hall of Fame is located at "Gate A" of BC Place, north of the Terry Fox Memorial Plaza (closest intersection – Robson and Beatty Streets)

Q. Where is parking located?

A. The BC Sports Hall of Fame is located within BC Place, which has nearly a dozen large parking lots and parkades within a two-block radius. In addition, there is metered parking on Robson Street and Beatty Street.

- a. During the period of the 2010 Winter Games, it is highly recommended to take the SkyTrain or taxi to the BC Sports Hall of Fame.

Q. Is there an area for unloading/loading?

A. For loading and unloading of an event, access to the concourse in front of the BC Sports Hall of Fame is available:

Driving – heading north on Beatty Street, turn right into parking lot (in between Robson and Georgia) that belongs to the Industry building in front of BC Place. With prior notice to the BC Sports Hall of Fame, the yellow stanchions will be removed and you will be able to drive onto the concourse. Park beside the “Gate A” revolving doors and air lock entrance to load into the BC Sports Hall of Fame.

Please note that delivery restrictions will apply effective February 1, 2010.

Event Details

Q. Is there a kitchen available for catering use?

A. There is a small kitchen available, with sink and fridge. There is no oven or stove available. Also available for food preparation or storage is a boardroom, adjacent to the Olympic Inspirations Gallery.

Q. Is alcohol allowed?

A. Yes, but the organizer must obtain a Special Event Liquor License and present proof to the BC Sports Hall of Fame seven days prior to the event.

Q. Are we able to put up decorations/posters?

A. No decorations/posters may be put up without the prior approval of the BC Sports Hall of Fame. Restrictions apply in order to restrict damage to the walls, photos and artifact cases.

Branding restrictions apply in the *Olympic Inspirations*® Gallery and 2010 Exhibit Space – corporate signage is limited to the stage.